

RSC SERIES

SELF-CLEANING ROTARY VALVES FOR STICKY, VISCOUS & NON-FREE FLOWING BULK MATERIAL HANDLING

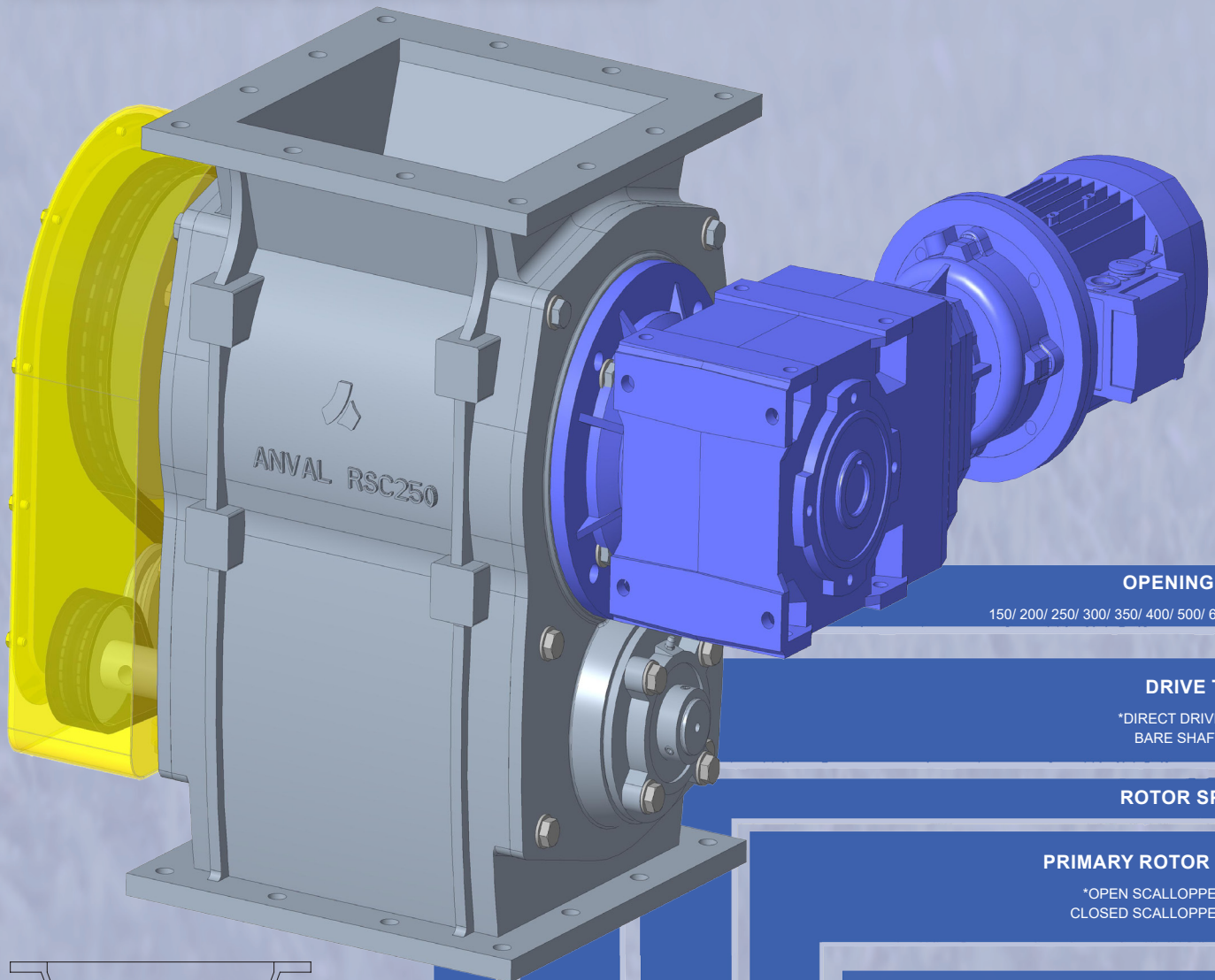

OPENING SIZE

150/ 200/ 250/ 300/ 350/ 400/ 500/ 600/ 750

DRIVE TYPE

*DIRECT DRIVE : D
BARE SHAFT : B

ROTOR SPEED

PRIMARY ROTOR TYPE

*OPEN SCALLOPPED : Q
CLOSED SCALLOPPED : N

PURGE SEALING

AIR PURGE # : A

For temperature > 300 °C

@ TEMPERATURE RANGE

200 - 300 °C : X
300 - 400 °C : Y
> 400 °C : Z

@ ACCESSORY

PROXIMITY SENSOR : P

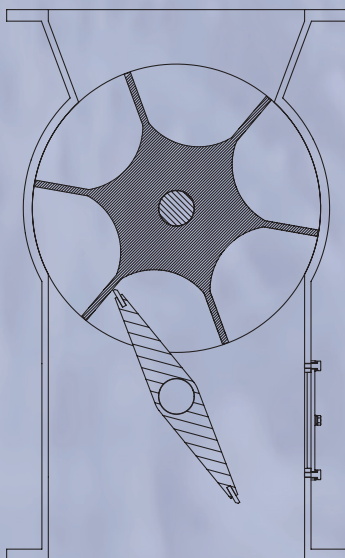

RSC	250	D	*14	Q	A	-	-
BASIC DESIGNATION				EXTENDED DESIGNATION			

* DEFAULT
MANDATORY
@ OPTIONAL

DIRECT DRIVE (D) > DIMENSIONS

RSC

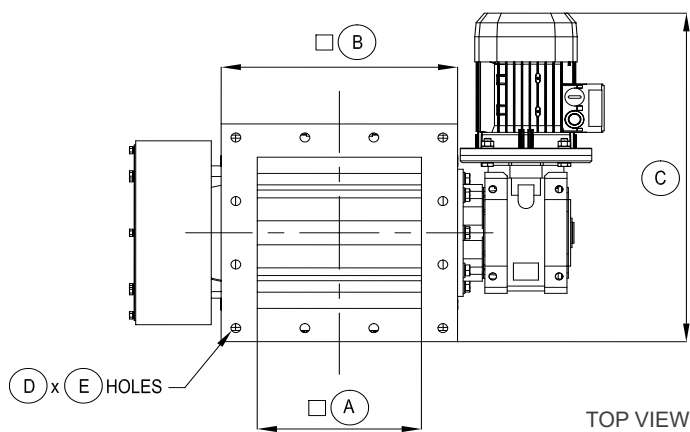

NAME	RSC 250	RSC 400
A	• 250	• 400
B	360	530
C#	543	770
D	12	20
E	Ø 15	Ø 15
F	345	550
G	723	1047
H	550	890
I	320	426
J#	403	621
NET WEIGHT	250	450
GROSS WEIGHT	310	550

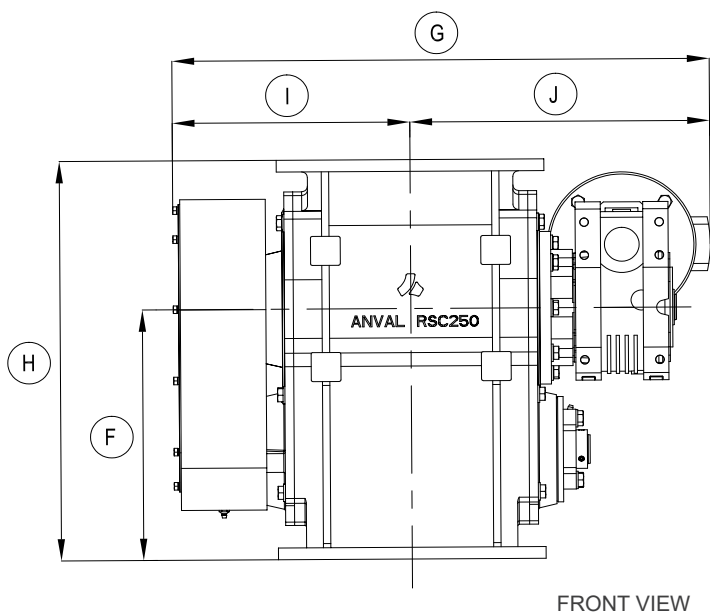

ALL DIMENSIONS IN MM, WEIGHT IN KGS.

APPROXIMATE DIMENSION ONLY. VARIES WITH MOTOR SIZE AND GEARBOX VARIATION.

NOTE: MAINTAIN OIL LEVEL IN CHAIN GUARD SUCH THAT CHAIN BOTTOM IS DIPPED IN OIL. USE LUBRICATION OIL 320GRADE.

PROXIMITY SENSORS

RSC

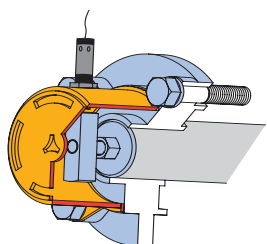

Underspeed sensors can be supplied and fitted to rotary valves. These are mounted on a specifically designed bracket that is bolted onto the bearing. By default, the sensor fitted is 12mm in diameter with CD-PNP electrical connection and protection to IP67. The unit is suitable for temperatures from -25°C to +70°C.

EXPLODED VIEW

RSC

Anval's Rotary Self-Cleaning valve RSC Series, which is designed to win-over Chocking issues in handling sticky, viscous and non-free flowing bulk solids. RSC Series Rotary Valves are in complete cast construction with internal surfaces machined to high precision, ideally suited for animal waste, clay, starch, active ingredients, fertilizer, pulp, fibers, phosphates, sludge, salt and so on.

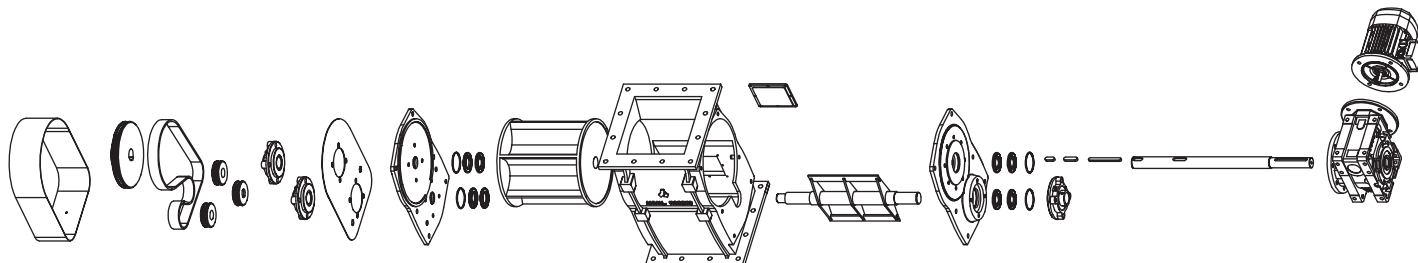

APPROXIMATE DIMENSION ONLY. VARIES WITH MOTOR SIZE AND GEARBOX VARIATION.

ROTORS

RSC

The standard RSC Series primary rotor is open scalloped type, which has the least amount of potential wear. Scallopped closed rotors are provided based on the application.

The secondary rotor drives via chain transmission and the sprockets set to rotation for the easy wiping action on primary rotor and inturn facilitates the easy flow of material.

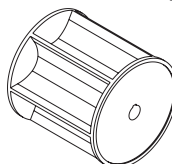

CLOSED SCALLOPPED ROTOR

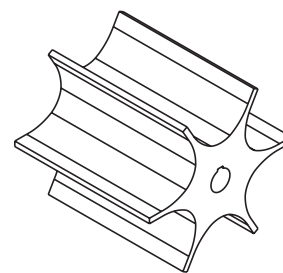

OPEN SCALLOPPED ROTOR

SHAFT SEALING

RSC

We are using labyrinth seal, which is a mechanical seal that fits around the axle or shaft to prevent the leakage of any particles. Generally, Labyrinth seal is composed of many threads or grooves that are tightly fit inside the casing, thus making difficult for the dust to pass through a long and difficult path.

Labyrinth seals on rotating shafts provide non contact sealing action by controlling the passage of particles through a variety of chambers by centrifugal motion, as well as by the formation of controlled material vortices.

'Double labyrinth Seals' are filled with flock pads, on each side of the valve. These are standard with all RSC Series valves.

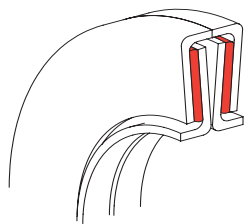

LABYRINTH SEAL

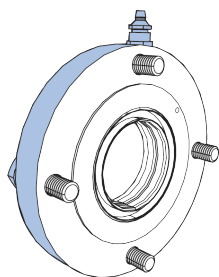

AIR PURGE SEALING

Air Purge - For high temperature applications, air or other gases can be used to purge the seal so all dust particles or product gases are flushed back into the product stream.

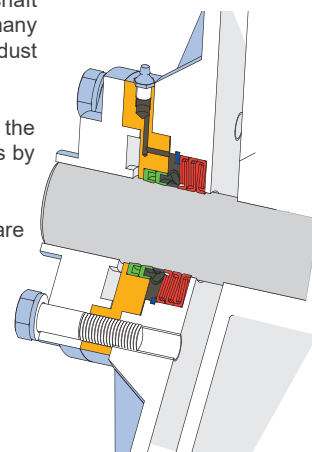

TYPICAL PURGE SEALING ARRANGEMENT

MODEL SELECTION CHART

Speed Vs Throughput

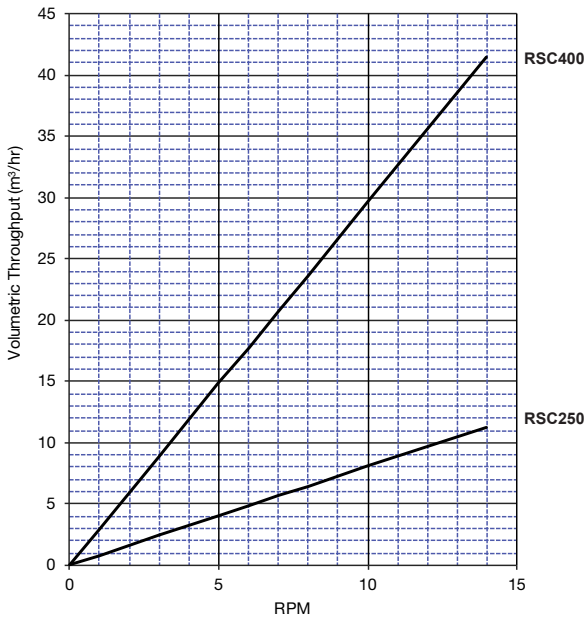

Capacity Chart

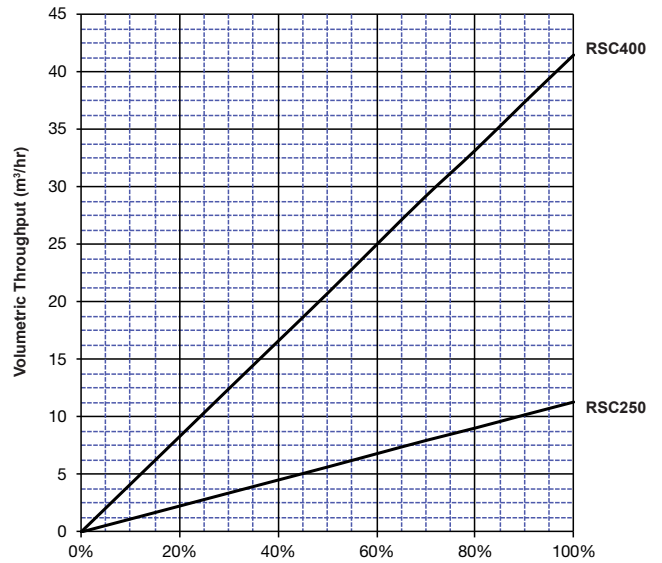

- 14 RPM DEFAULT FOR DIRECT (D)
- RPM NOT REQUIRED FOR BARE SHAFT

NOTE: THIS CHART IS PREPARED FOR THE GUIDANCE PURPOSE ONLY, CONSIDERING 100% FILLING CAPACITY.

NOTE: THIS CHART IS PREPARED FOR THE GUIDANCE PURPOSE ONLY, CONSIDERING 100% FILLING CAPACITY.

CONSTRUCTION / TECHNICAL SPECIFICATIONS

BODY	: Cast Iron / Carbon Steel / Stainless Steel	SHAFT	: EN8, SS304, SS316
ROTOR	: Cast Iron / Carbon Steel / Stainless Steel	OPENING SIZES	: 150, 200, 250, 300, 350, 400, 500, 600, 750 mm
SIDE PLATES	: Cast Iron / Carbon Steel / Stainless Steel	TEMPERATURE	: Build to eminent temperature
GEARBOX	: Heliworm or Helibevel Gears	DIFFERENTIAL PRESSURE	: Can handle higher pressure
SEALS	: Labyrinth Seals (Sealing Washers)	CAPACITY RANGE	: Upto 500 m³/hr Max.
DRIVE TYPE	: Direct / Bare shaft	PAINTING STANDARD	: Dark Grey Blue
ROTOR TYPE	: Open Scalloped Rotor (Q) / Closed Scalloped Rotor (N)	SURFACE TREATMENT (ANVAL STANDARD)	: 50µm Grey Primer 50µm Paracryl IFC (B53 Dk. Grey Blue / Y14 Golden Yellow for guards)
SENSOR	: Proximity Sensor (P)	SURFACE TREATMENT (HIGH TEMPERATURE)	: 75µm ES600 Zinc Silicate Primer 40µm Heatkote Aluminium
SPECIAL SEALS	: Air Purge (A)		
BEARINGS	: Cartridge Type		

NOTE: SPECIAL CONSTRUCTIONS ARE AVAILABLE FOR HIGHER DIFFERENTIAL PRESSURE AND TEMPERATURE.



OUR LOCATIONS

OCEANIA

+61 8 9726 0988

INDIA

+91 74492 00 505 / 432

EUROPE

+44 (0) 333 012 4164

SOUTH EAST ASIA

+65 (0) 9820 6236

www.anval.net | info@anval.net